

**SPECIFICATIONS**

Current Rating: 3Amps/Contact Max.  
 Contact Resistance: 4 Milliohms/Contact  
 Insulation Resistance: 1000 Megohms At V=100V  
 Operating Voltage: 60VAC/DC  
 Average Insertion Force With Steel Pin Of  $\phi 0.43\text{mm}/0.17''$ : <250g  
 Average Withdrawal Force With Steel Pin Of  $\phi 0.43\text{mm}/0.17''$ : >50g Min  
 Mechanical Life Cycle: Min.200  
 Operating Temperatures: Gold Plated:  $-55^{\circ}\text{C}$  To  $+125^{\circ}\text{C}$   
 Tin Plated:  $-40^{\circ}\text{C}$  To  $+105^{\circ}\text{C}$   
 Soldering Temperature:  $+260^{\circ}\text{C}$ , 10s Max.  
 Pin(Outer Sleeve): Brass, Machined CuZn 38Pb2  
 Clip(Contact 4 Finger): Beryllium Copper, Heat Treated  
 Plating (Outer Sleeve): Tin Plated  
 Plating (Contact): Gold Plated  
 Insulator(Black): Glass Filled Thermoplastic Polyester UL94V-0

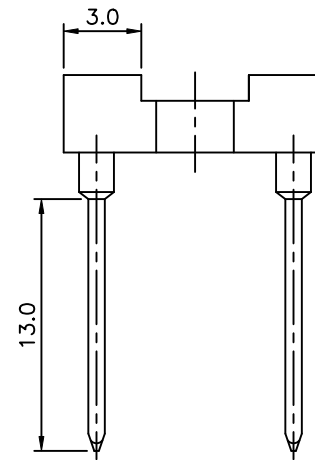
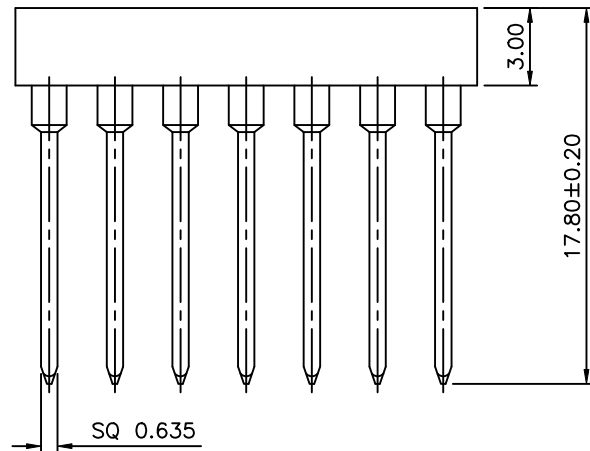
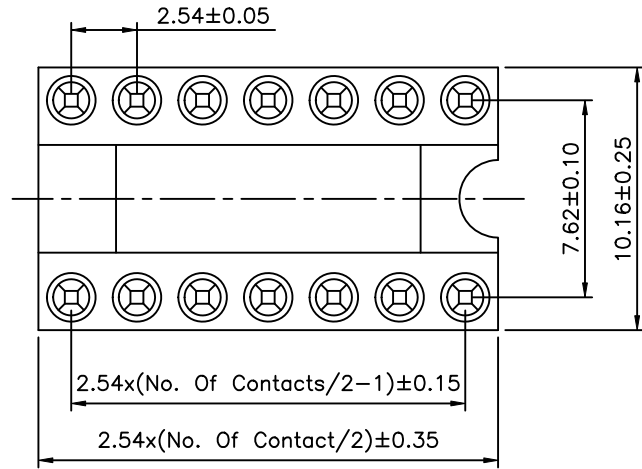

**4UCON** 元化興業股份有限公司  
 4UCON TECHNOLOGY INC.

DRAWING No.

05919

SCALE

NONE

APPROVED BY

MEI

CHECKED BY

HZF

DRAWING BY

PEGA

REV.

A0

UNLESS OTHERWISE SPECIFIED TOLERANCES ARE

X.  $\pm 0.35$   
 .X  $\pm 0.20$   
 .XX  $\pm 0.15$   
 .XXX  $\pm 0.05$   
 ANG  $\pm 5^{\circ}$

UNIT

mm



NO. REV.

A0

NEW RELEASE

REVISIONS

HZF

CHK

DATE

10/30/2006

DATE